

【Compatibility】 SYE12/ASE12/AS90/GSR260Z Series

【Assembly steps】

- ① Assemble the tail slide ring. Please note that it has a reverse thread.
 - ② Install the tail PC link to the tail PC plate using the HG tail PC link pin.
 - ③ Once the E stopper ring is installed, tighten the setscrew M2 x 2.
 - ④ Install the joint ball screw L4 to the HG metal tail blade holder.
 - ⑤ Install the O-ring 3.5×5.5×1 to the HG center hub first. Then install the HG metal tail blade holder, washer 8×10×0.5, thrust bearing 5×10×4, flat washer M3, and the socket head bolt M3×8 in this order.
- The thrust bearing has a front and back. Do not make a mistake when installing it.
- ⑥ Install the assembled tail PC plate to the tail output shaft first. Next install the tail hub and secure the setscrew M4×4.
 - ⑦ Install the tail PC link and confirm everything moves smoothly.

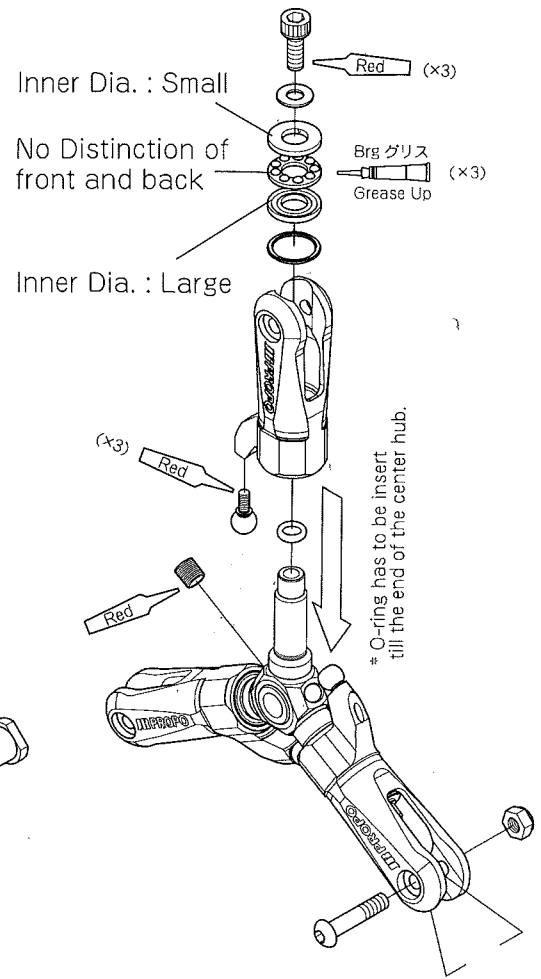

※NOTE : Lower the gyro gain of the rudder 10 to 20% when starting the flight.

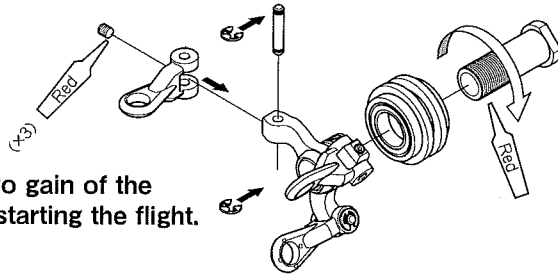

【Parts List】

Item #	Description	Qty.	Note
60556	Tail PC Link B	2	w/Link Pin · E Ring Stopper M1.5
61201	Tail Slide Ring	1	w/Bearing
61777	HG Metal Tail Blade Holder $\phi 5$	1	w/Bearing · Joint Ball Screw
62017	Carbon tail rotor blade XB105-TR3	1	Sold separately , 3-piece set
62032	TR3 Tail PC Plate	1	
62033	TR3 Center Hub $\phi 5$	1	
70163	O-ring 3.5×5.5×1	2	
70293	HG Tail PC Link Pin	2	
70528	Tail Slide Ring Sleeve	1	for $\phi 5$
70545	Washer 8×10×0.5	2	Spindle Shim Washer
70661	Joint Ball Screw L4	5	
80004	Setscrew M4×4	10	
80013	Socket Head Bolt M3×8	10	
80036	Flat Washer M3	10	
80039	Nylon Lock Nut M3 (t2.8)	10	
80245	Setscrew M2×2	5	w/HEX Wrench 0.89
80266	Tail Blade Bolts Set (Silver)	1	Bolt × 2, Nylon lock nut × 2
81016	E Stopper Ring M1.5	10	
81029	Thrust Bearing 5×10×4	2	T5-10
81071	Shielded Bearing 6×10×3	2	L-1060ZZ